

## BICYCLE MOTOR WORKS 66cc/80cc BIKE ENGINE PARTS

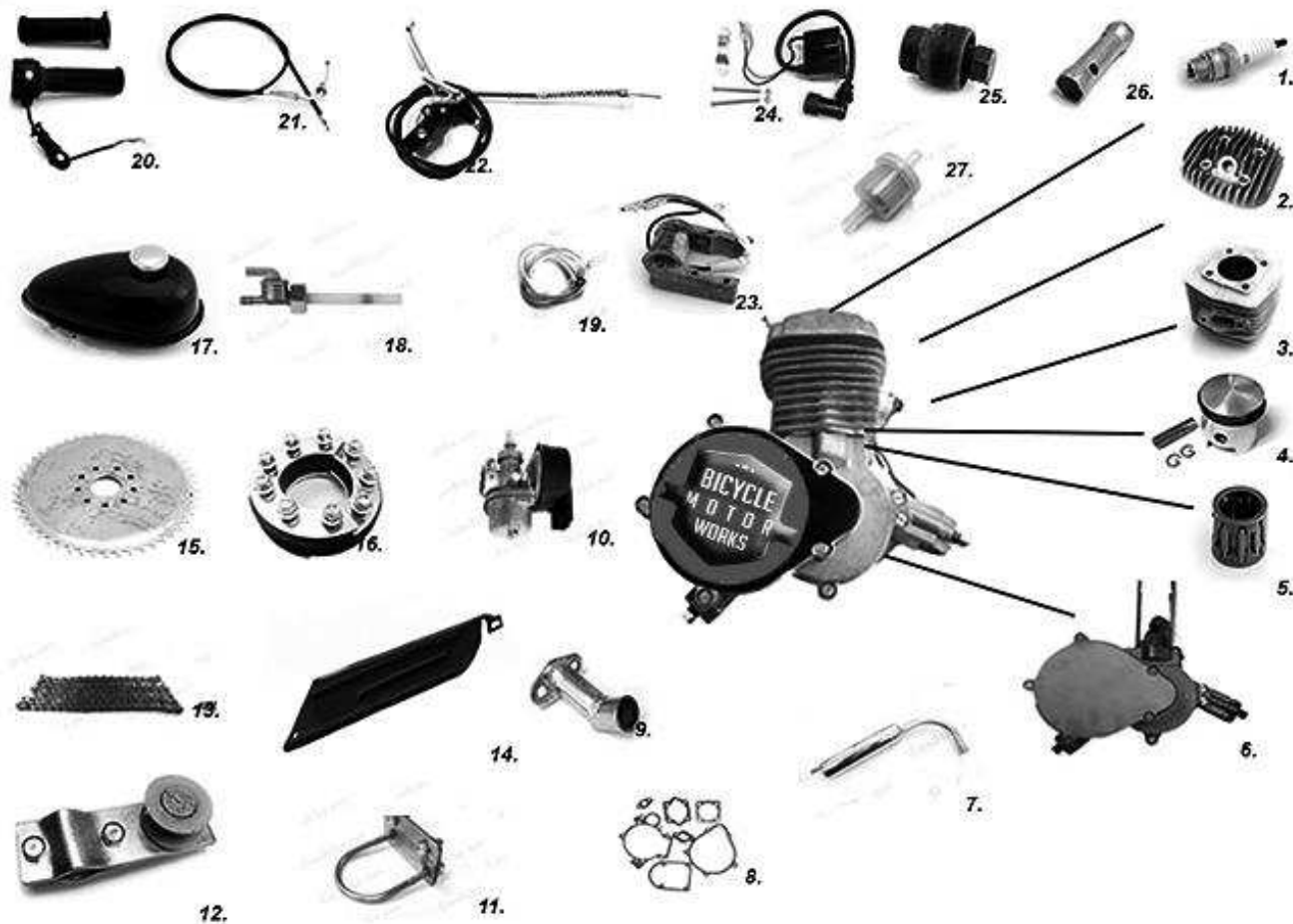

- |   |   |
|---|---|
| 1. Spark Plug                                   | 15. 44 Tooth Chain Sprocket                   |
| 2. Cylinder Slant Head Cover                    | 16. Pineapple Sprocket Brushing Kit           |
| 3. Cylinder Body                                | 17. Black 2.5 L Fuel Tank                     |
| 4. Piston Set                                   | 18. Gasoline Tank Switch (AL), Female Adapter |
| 5. Needle Bearing                               | 19. Fuel Line #2                              |
| 6. 66cc/80cc Bottom End                         | 20. Accelerograph Handle – Throttle Handle    |
| 7. Exhaust Muffler                              | 21. Accelerograph Line – Throttle Cable       |
| 8. 66cc Gasket Kit                              | 22. Clutch Handle – Complete Assembly         |
| 9. Air Intake Pipe                              | 23. Sparker Wire Loop Set – Magneto           |
| 10. NT Carburetor                               | 24. CDI – Coil                                |
| 11. Universal Mount Bolt                        | 25. Screw Tool                                |
| 12. Idler Pulley Chain Tension, 2 Bolts/bearing | 26. Head Bolt/Spark Plug Remover              |
| 13. #415 Heavy Duty Bike Chain                  | 27. Paper Fuel Filter                         |
| 14. Chain Protecting Casing                     |   |